

INSTALLATION INSTRUCTIONS

Ben Track Spotlight

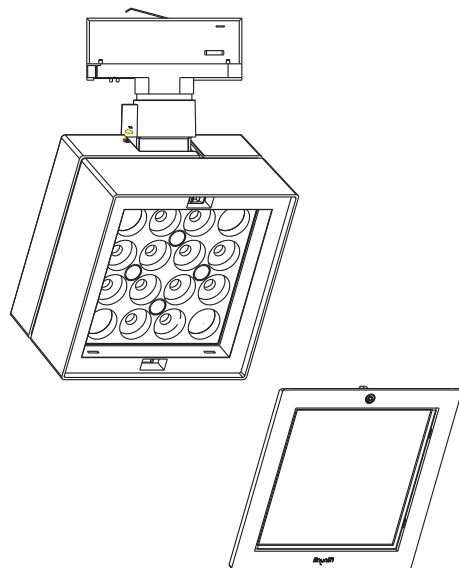

To customers:

- Thank you for choosing our products !
- Please read this instruction carefully before using the product.
- This manual should be retained for the future reference.

Please confirm the following important matters before starting each work, in order to ensure safe construction!			
If there is any problems with the product, please turn off the power supply and please consult our agent or ask qualified electrician.			
⚠ Warning: Wrong using may cause accidents.			
⚠ Caution: Incorrect using may cause damage.			
Before Installation	Warning	Forbidden to use	<p>This product is widely used in indoor application only and it cannot be used under the following environmental conditions. (Risk of Drop, Risk of Electric Shock, Risk of Fire)</p> <ul style="list-style-type: none"> • Where ambient temperature is under -10°C or above 45°C • Where humidity > 80%PH • Where air conditioner or air outlet exist • Where ceilings that cannot bear the weight of fixture • Where inclined and uneven ceiling exist • Where fixture is exposed to direct sunlight • Where dust and corrosive gas exist • Where vibration and shock exist • Outdoor Application • Where building insulation may be present in normal use <p>Please contact Customers Service Team, once use environment cannot be confirmed to be applicable or not.</p>
During Installation	Warning	To be carried out	<ul style="list-style-type: none"> • The fixture should be installed by a electrician with relevant qualification certificate. (Risk of Safety Accident) • Do not exceed the access voltage: 220-240V, frequency 50/60Hz. • The lighting circuit should be wired separately, compared with other power lines, such as air conditioners or high-power electric equipments. • Please make sure the power is switched off before installation or maintenance. And it's switched on only after correct wiring. (Risk of Electric Shock). • Don't disassemble or retrofit the fixture. (Risk of Electric Shock, Risk of Fire, Risk of Drop, Risk of Failure). • Don't touch the fixture when it is working or in a high temperature condition, when fixture just went out (Risk of Burning). • Don't operate by wet hands(Risk of Electric Shock).
	Caution	To be carried out	<ul style="list-style-type: none"> • The actual power is between 90%~110% from the rated power. (The load current carrying capacity of the wire should be considered in construction wiring). • The force bearing point of installation in the ceiling board must be 4 times higher than the fixture weight. (Risk of Drop or Damage) • The fire regulations must be observed, when fixture is working. (Risk of Fire) • Non-user replaceable light source: Light source of the fixture can only be replaced by manufacturer or specialized persons. • Please cut off the power supply immediately, if smoke or odor occur, then contact the electrical contractor. (Risk of Fire)

HUIZHOU CDN INDUSTRIAL DEVELOPMENT CO.,LTD.

No.A17,Xianghe West Rd., Dongjiang Ind.Zone,Shuikou, Huizhou, Guangdong, China
<http://www.mayalit.com>

Installation instructions:

1. This product is compatible with Mayalit brand track (Fig.1) or other compatible rails from third-party manufacturers. track parameters:input voltage: AC 220-240V; Max current: 16A;
2. Confirm the installation plan, ensuring sufficient space and no interference with building structures;
3. Before installation , adjust the handle to the position shown in Fig.2 prior to installation.
4. Align the protruding ribs on the side of the connector with the corresponding grooves on the track. Push the connector into the track slot (Fig.3).

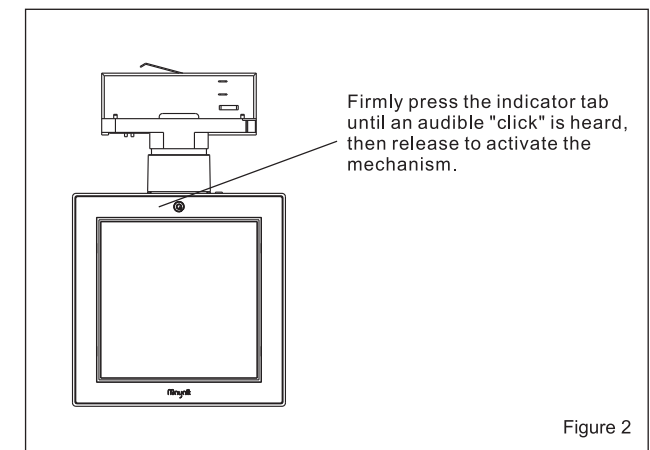
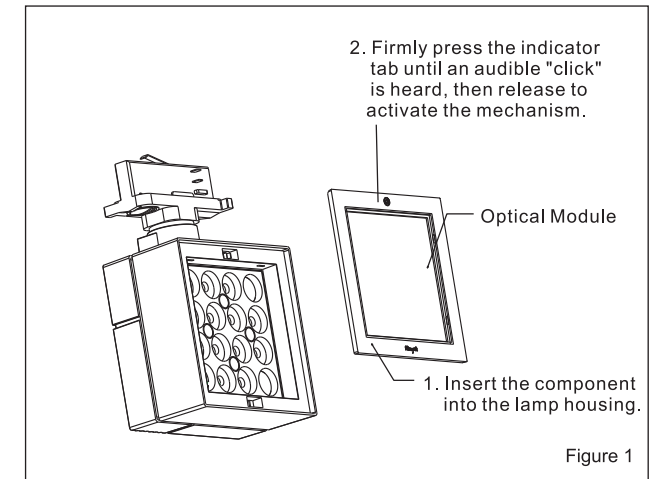

5. Before installation, adjust the handle to the position shown in the diagram. Then insert the adapter into the guide rail slot according to the illustrated position, as shown in Figure 3.

6. Rotate the handle clockwise to the locked position (Figure 4).

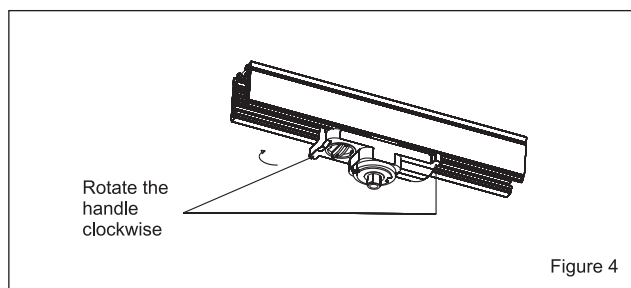
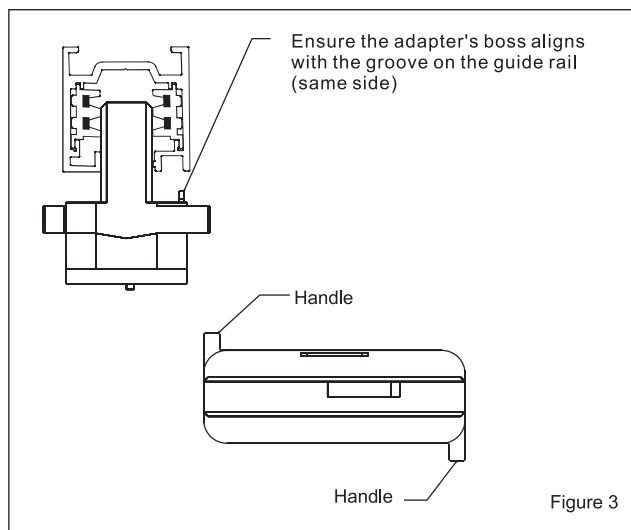

7. Adjust the gear adjustment knob. When the indicator arrow aligns with the gear number, that gear is activated (Figure 5).

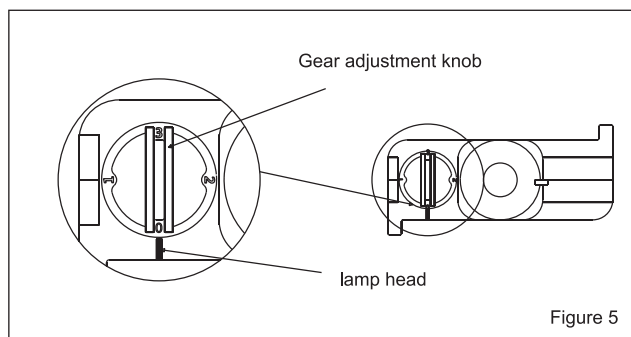

8. After installation, the light fixture can rotate 360° horizontally and 90° vertically. Once the vertical angle is adjusted, securely tighten the hex socket set screw to fix the light's irradiation angle and prevent the light panel from sagging.

Note: Before adjusting the light angle, use a hex key to loosen this screw, then make adjustments (Figure 6).

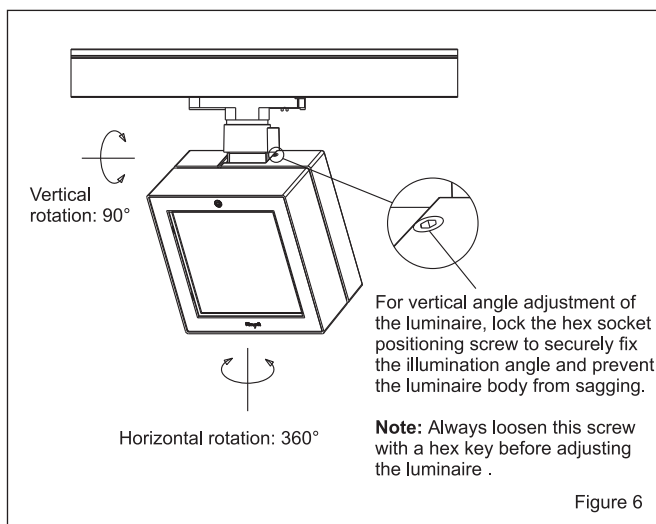

9. Dimmable & color temperature adjustable model:

* Rotate the dimmer knob (DIMMER) to adjust the brightness of the luminaire.

* Rotate the four-step color temperature knob (CCT1) to select the desired color temperature level.

* Rotate the fine-tuning color temperature knob (CCT2) for precise color temperature adjustment, with each step corresponding to a 10–30K change.

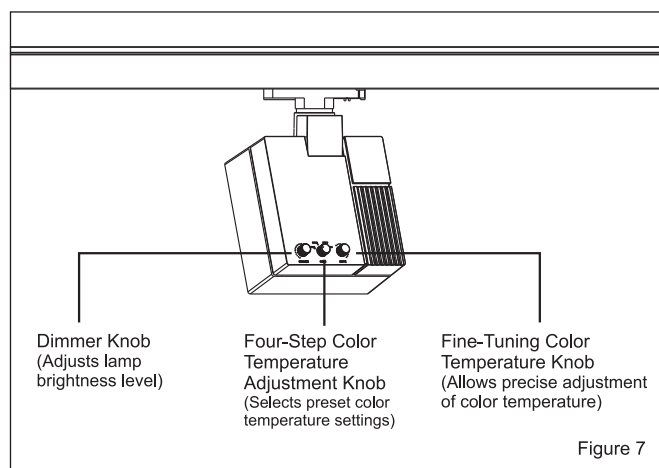

Dimmable model:

* Rotate the dimmer knob (DIMMER) to adjust the brightness of the luminaire; (Figure 8)

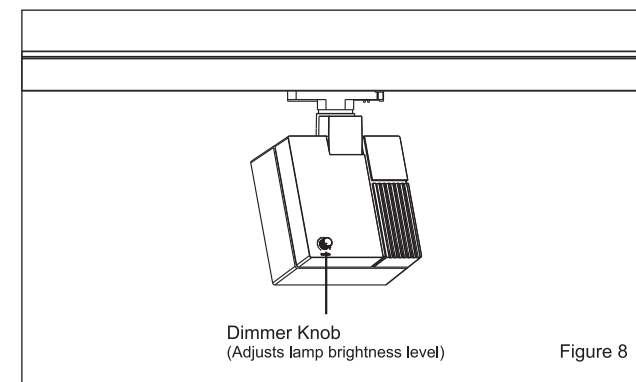

10. Load capacity chart (Figure 9).

